

Expansion of Imin-Fabrik - Germany

Engineering services for a chemicals production unit

- **Client:** BASF Ludwigshafen
- **Contractual scheme:** FEED Services
- **Scope of Work**
 - FEED Services for a new manufacturing plant for specialty monomer for water soluble polymers in Ludwigshafen, Germany
 - Cost Estimate TIC
 - FEED Package Preparation

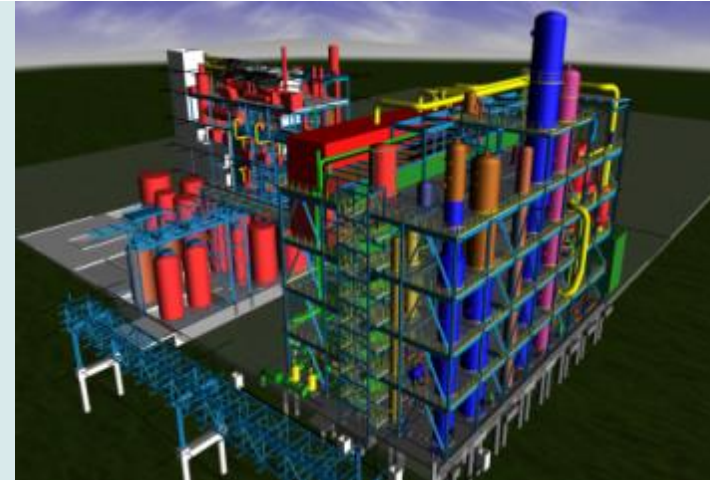

Technical Details

- Specialty monomer for water soluble polymers is an important feedstock for water soluble, cationic polymers to increase the efficiency of the production process in the paper industry.
- This product line allows paper manufacturers to produce more environmentally friendly and lower their costs.